

# KDP Family Dollar Football Display - Assembly Instructions

JOB 18581

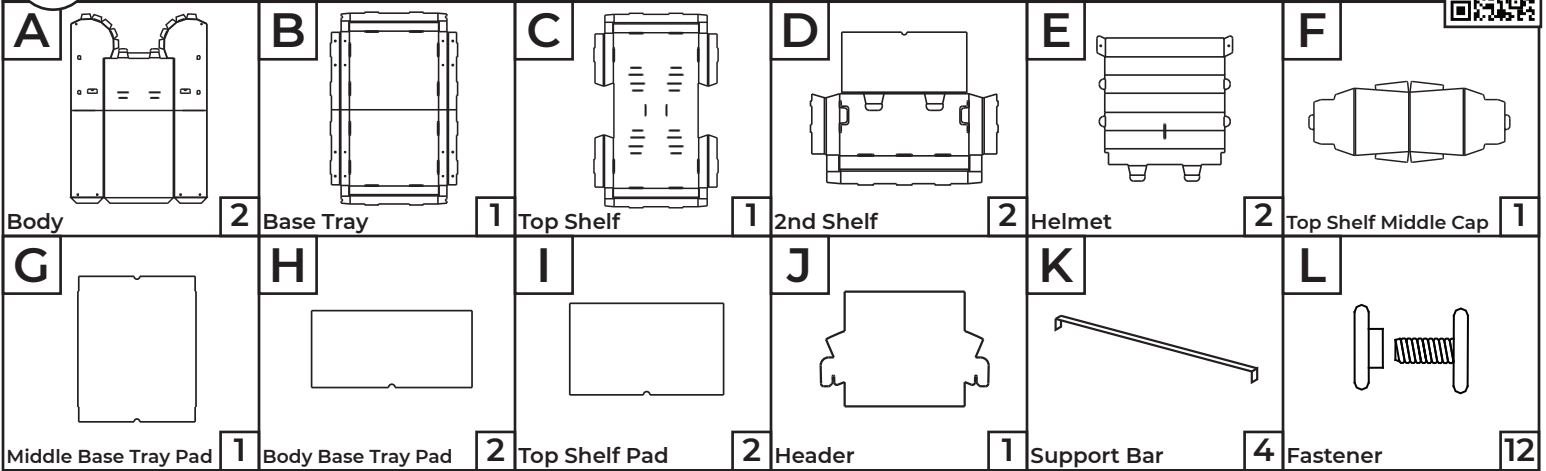

Scan the QR code or visit the web address directly to view the assembly video: [displaybuilds.com/instructions\\_18581](http://displaybuilds.com/instructions_18581)



**1** Assemble (B) Base Tray and (C) Top Shelf by folding as shown.

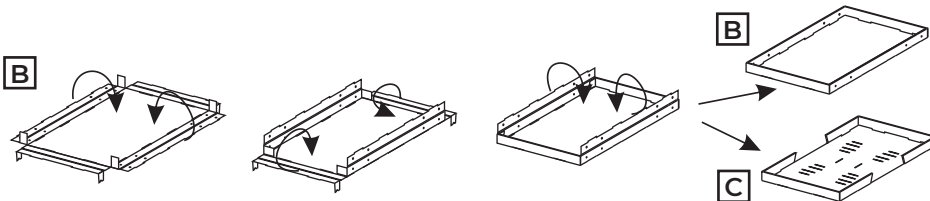

**2** Assemble both (D) 2nd Shelves as shown below.

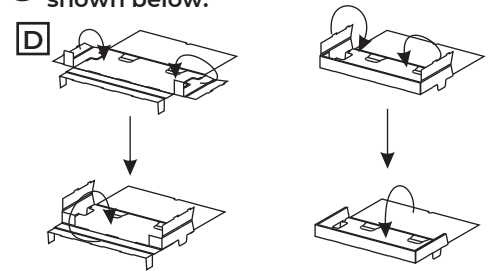

**3** Square up the (A) Body by folding side panels forward.

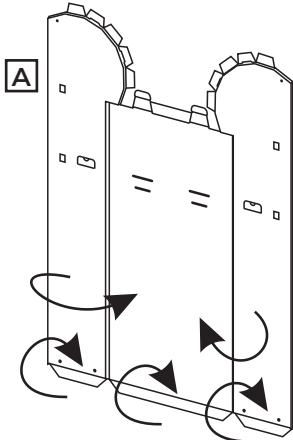

**4** Insert both (A) Main Bodies into the assembled (B) Base Tray as shown below.

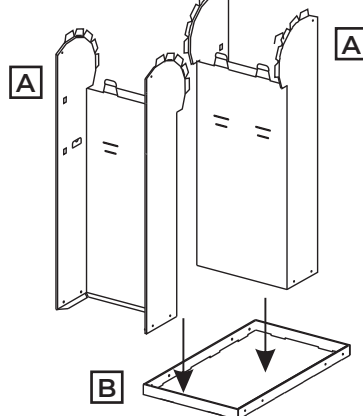

**5** Insert the (H) Body Base Tray Pad on both sides and the (G) Middle Base Tray Pad in the center. Attach both (A) Bodies to (B) Base Tray with x8 (L) Fasteners.

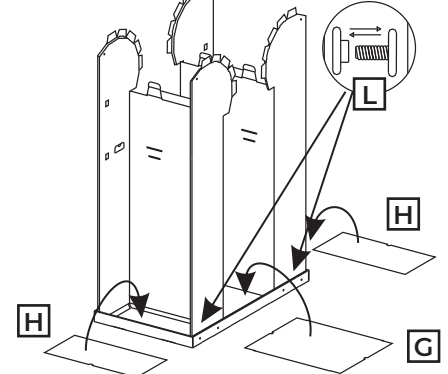

**6** Insert (K) Support Bars into the lower slots on each (A) Body as shown.

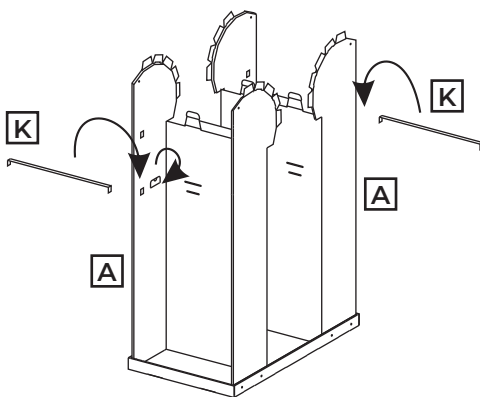

**7** Insert the tabs of each (D) 2nd Shelf into the side panels of the (A) Body, then insert the back tab through the top slot at the back of the (A) Body; fold tab down and insert back through the bottom slot to lock into place.

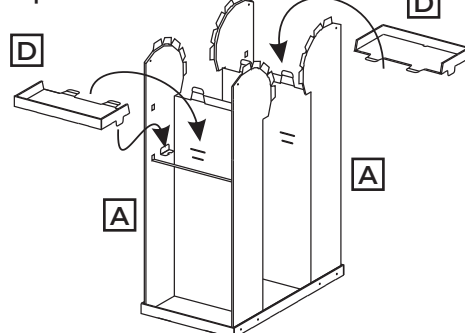

**8** Insert (K) Support Bars into the higher slots on each (A) Body as shown.

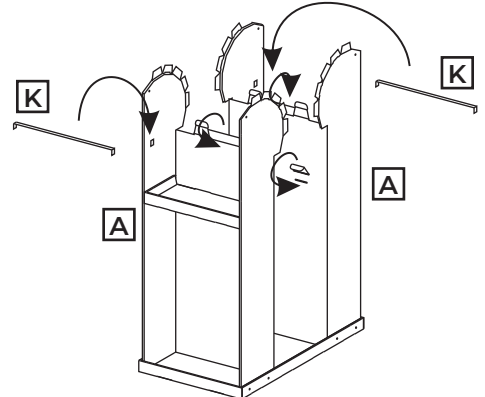

# KDP Family Dollar Football Display - Assembly Instructions

JOB 18581



Scan the QR code or visit the web address directly to view the assembly video: [displaybuilds.com/instructions\\_18581](http://displaybuilds.com/instructions_18581)



**9** Insert the top tabs at the back of each (A) Body into the (C) Top Shelf and slide the shelf down and into place. Then fold each tab over and lock into the corresponding slot to lock (C) Top Shelf into place.

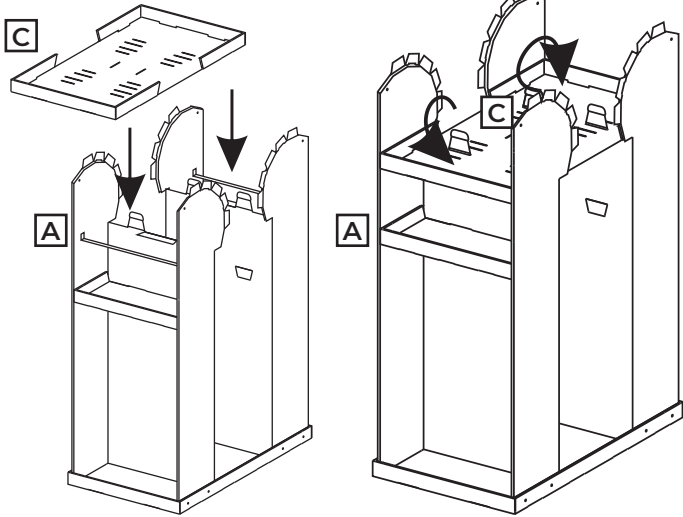

**10** Arrange the (F) Top Shelf Middle Cap as shown, wrap around (C) Top Shelf, and insert tabs to lock into place.

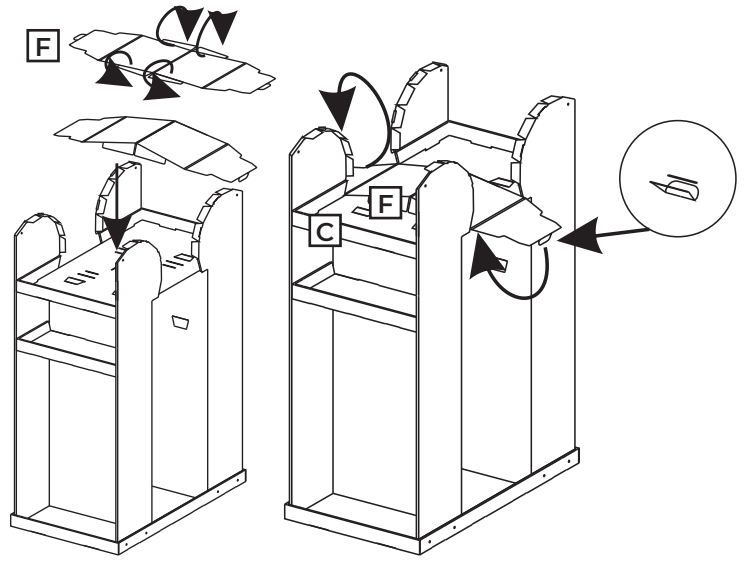

**11** Insert the (E) Helmet tabs into the corresponding slots on the (C) Top Shelf.

Then fold around the (A) Body sides and insert corresponding tabs.

Repeat to install other (E) Helmet on opposite side.

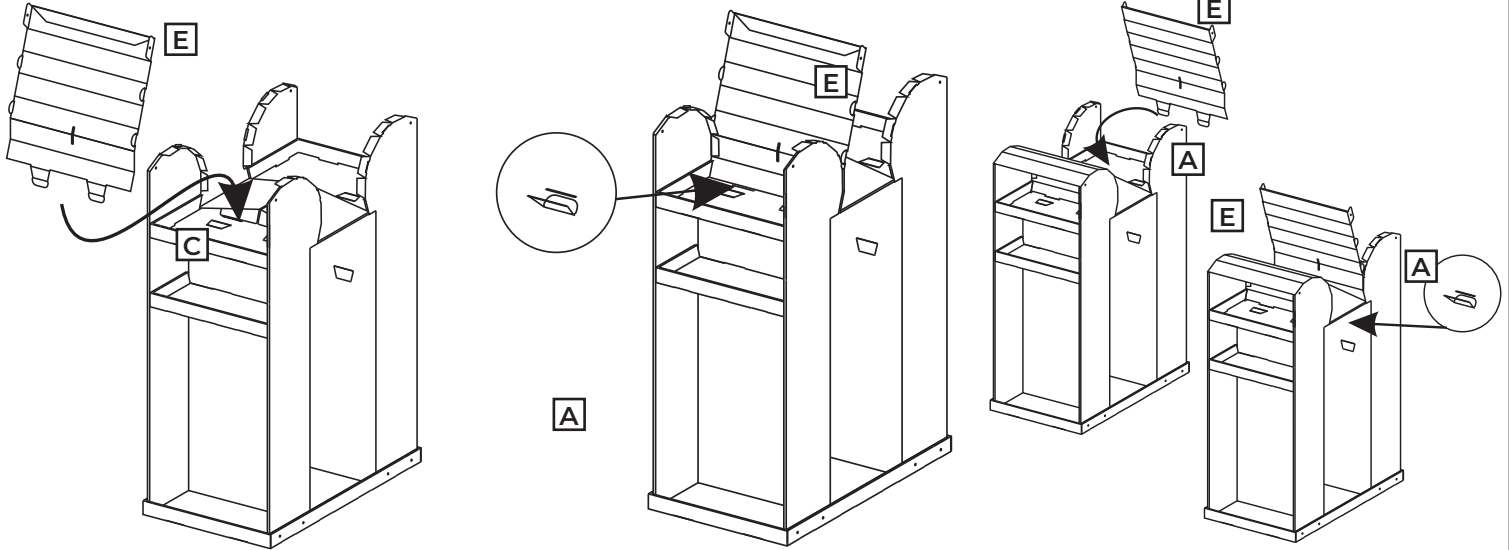

**12** Secure each (E) Helmet to each (A) Body with x4 (L) Fasteners.

**13** Insert (I) Top Shelf Pads into each (C) Top Shelf.

**14** Insert the (J) Header into each (E) Helmet and the (F) Top Shelf Middle Cap.

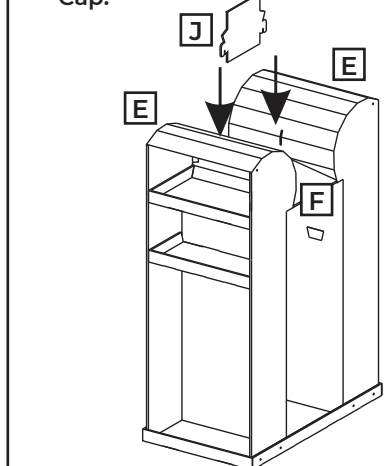
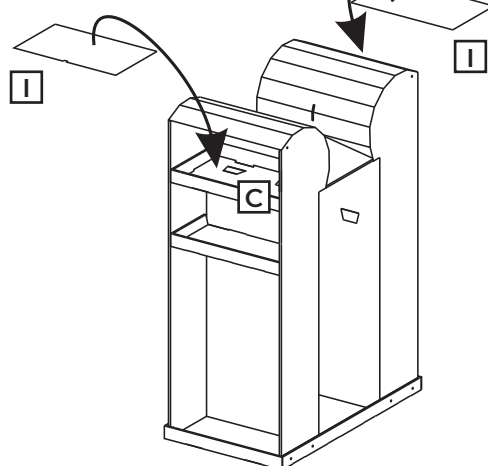
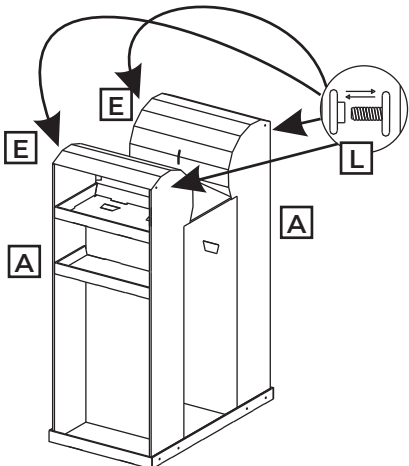



Scan the QR code or visit the web address directly to view the assembly video: [displaybuilds.com/instructions\\_18581](https://displaybuilds.com/instructions_18581)

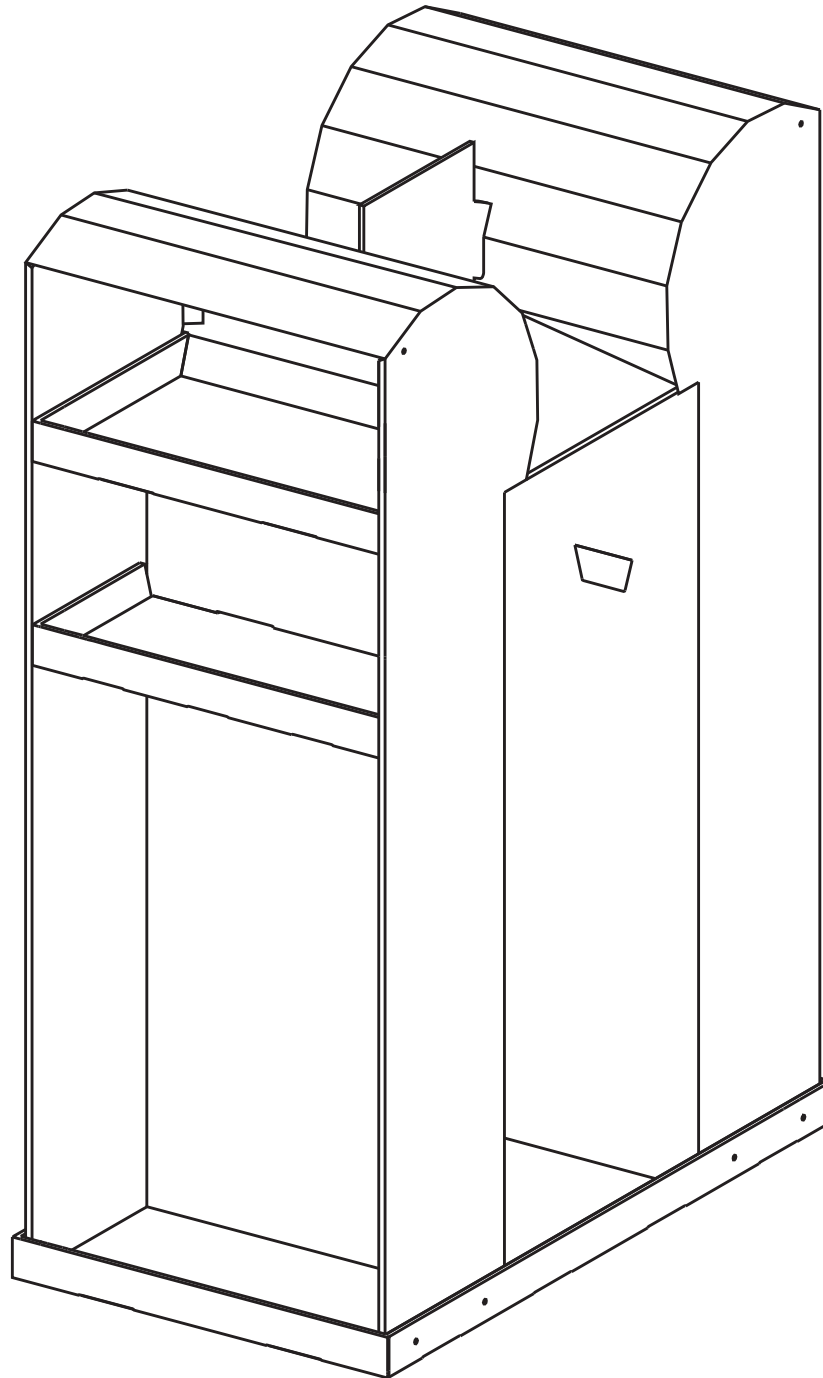

## MISSING PARTS / DAMAGE CLAIM INSTRUCTIONS

1. **DO NOT** discard the box or original packaging.

In the case of damaged goods caused by shipping, photo evidence will be required.

2. Take photos of the box & markings.

A photo of the markings (text) on the side of the box is required for all cases in which a replacement part is needed. This helps to identify the item number and ensures the correct parts are pulled.

3. Take photos of damage (if applicable).

A photo of the damaged part(s) is always required to file a claim and expediently process the replacement part. Please make sure you keep the box even if it is damaged.

4. Send an email with the images requested.

Email a description of the claim along with the images required above at [displaybuilds.com/contact](https://displaybuilds.com/contact) or directly to [help@displaybuilds.com](mailto:help@displaybuilds.com). Call our toll-free number 1-866-308-8368 for further assistance.