

CASO DP Football Cheerleader - Assembly Instructions

JOB 18614



Scan the QR code or visit the web address directly to view the assembly video: displaybuilds.com/instructions_18614



A Body 1	B Skirt 1	C Hand 1 1	D Hand 2 1	E Leg 1 1	F Leg 2 1
G Shoes 2	H Neck 1	I Head & Hat 1	J Skirt Supports 2	K Header Card 1	L Metal Foot 2

1 Assemble (A) Body by folding and locking tabs as shown below.

2 Interlock (J) Skirt Supports as shown. Then remove tape backing on (B) Skirt and stick together. Insert the assembled Skirt Supports into skirt.

3 Fold over and lock tabs at bottom of (B) Skirt as shown.

4 Assemble (C) Hand 1 (marked R) & (D) Hand 2 (marked L) by folding and locking tabs as shown below.

5 Assemble (E) Leg 1 (marked R), (F) Leg 2 (marked L), and (G) Shoes by folding and locking tabs as shown

6 Insert the assembled (E & F) Legs into (G) Shoes and lock tabs as shown below.

CASO DP Football Cheerleader - Assembly Instructions

JOB 18614



Scan the QR code or visit the web address directly to view the assembly video: displaybuilds.com/instructions_18614



7 Assemble (H) Neck as shown below. Remove tape backing on (I) Head & Hat and secure as shown.

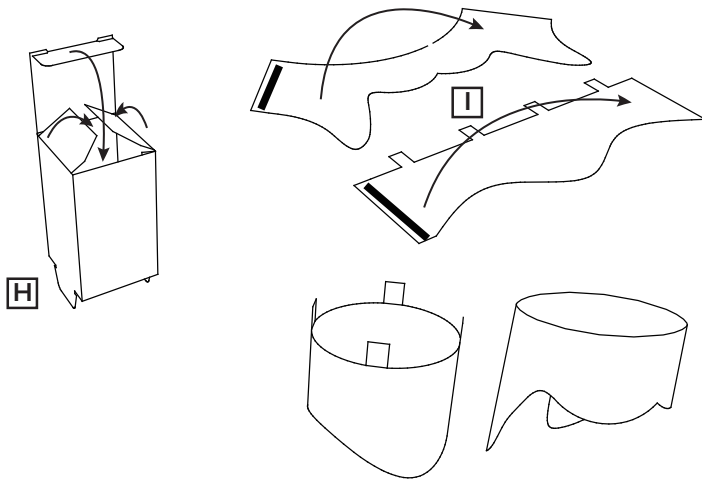

8 Place the assembled (I) Head & Hat on assembled (H) Neck as shown.

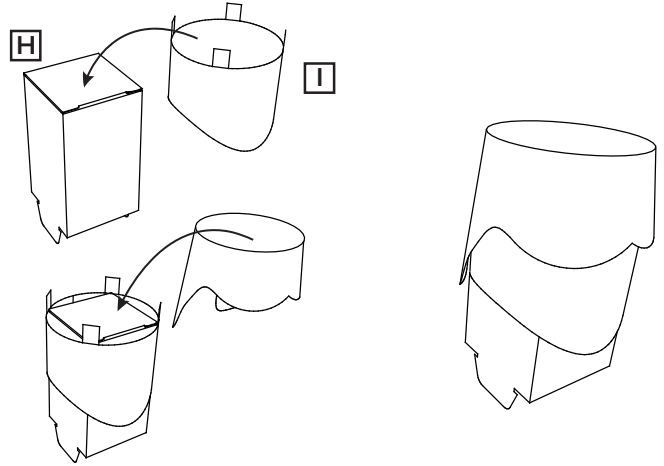

9 Insert assembled (E & F) Legs into assembled (B) Skirt slots and secure.

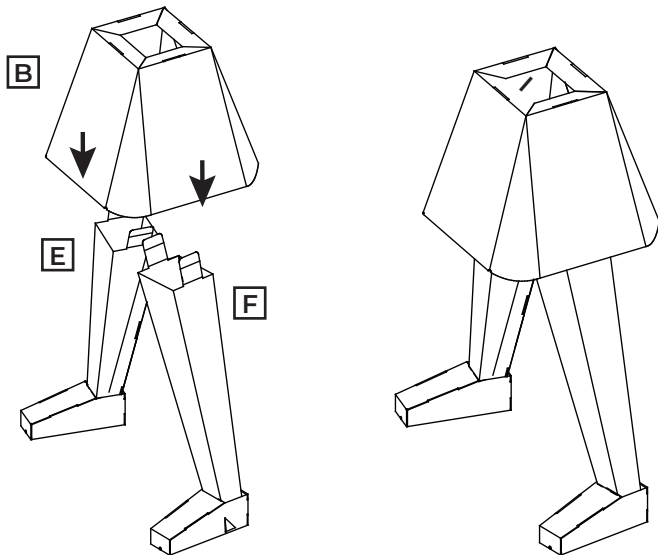

10 Insert the assembled (A) Body into the (B) Skirt as shown below.

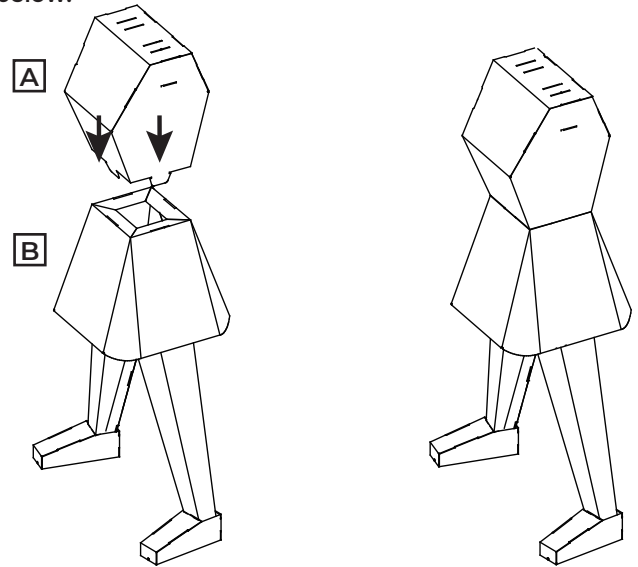

11 Insert the assembled (H) Neck with (I) Head & Hat into the (A) Body as shown below.

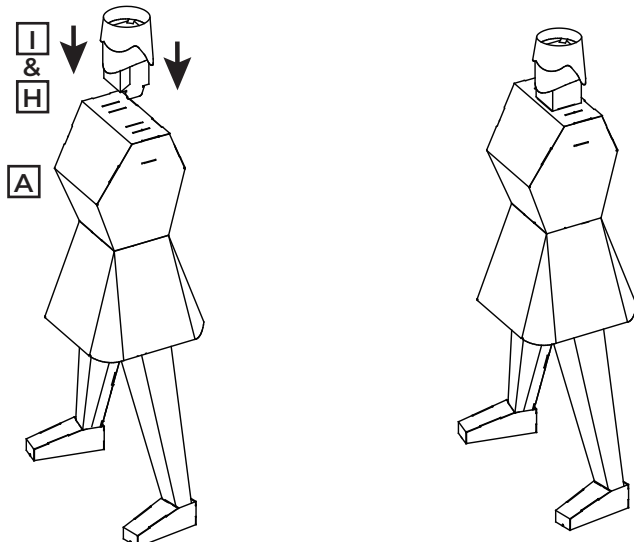

12 Insert the (C & D) Hands into the (A) Body as shown below.

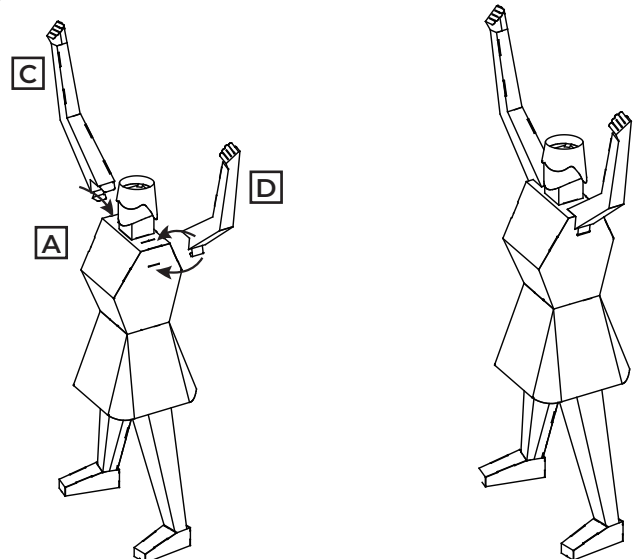



Scan the QR code or visit the web address directly to view the assembly video: displaybuilds.com/instructions_18614



13 Remove tape backing and attach (K) Header to assembled (C & D) Hands. Insert a (L) Metal Foot into front of each (G) Shoe as shown below.

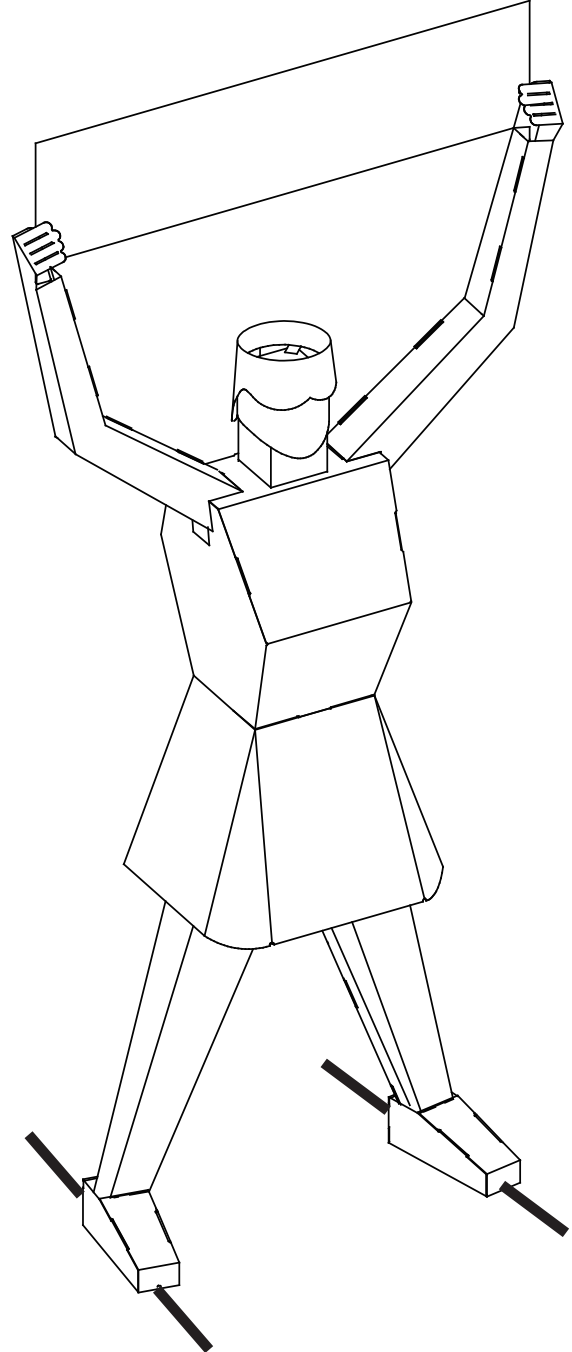
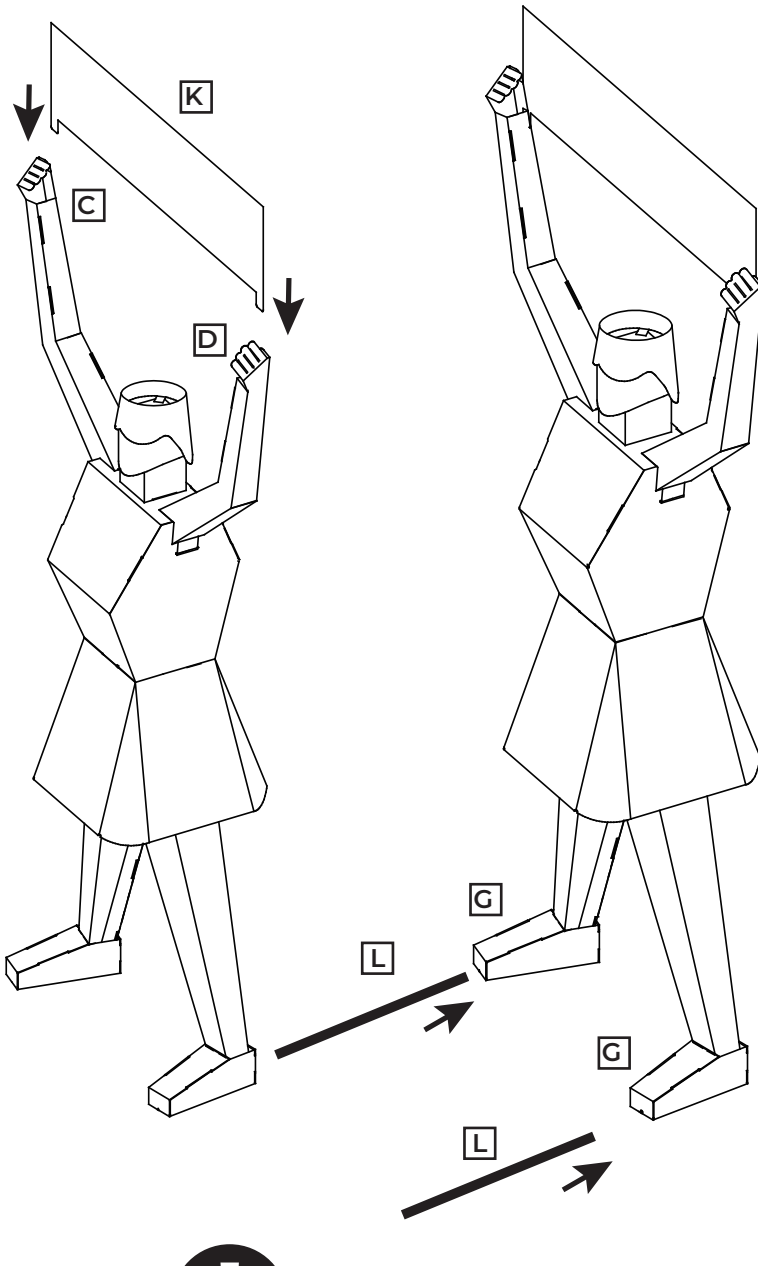

MISSING PARTS / DAMAGE CLAIM INSTRUCTIONS

1. **DO NOT** discard the box or original packaging.
In the case of damaged goods caused by shipping, photo evidence will be required.
2. Take photos of the box & markings.
A photo of the markings (text) on the side of the box is required for all cases in which a replacement part is needed. This helps to identify the item number and ensures the correct parts are pulled.
3. Take photos of damage (if applicable).
A photo of the damaged part(s) is always required to file a claim and expediently process the replacement part. Please make sure you keep the box even if it is damaged.
4. Send an email with the images requested.
Email a description of the claim along with the images required above at displaybuilds.com/contact or directly to help@displaybuilds.com. Call our toll-free number 1-866-308-8368 for further assistance.