

Scan the QR code or visit the web address directly to view the assembly video: displaybuilds.com/c4

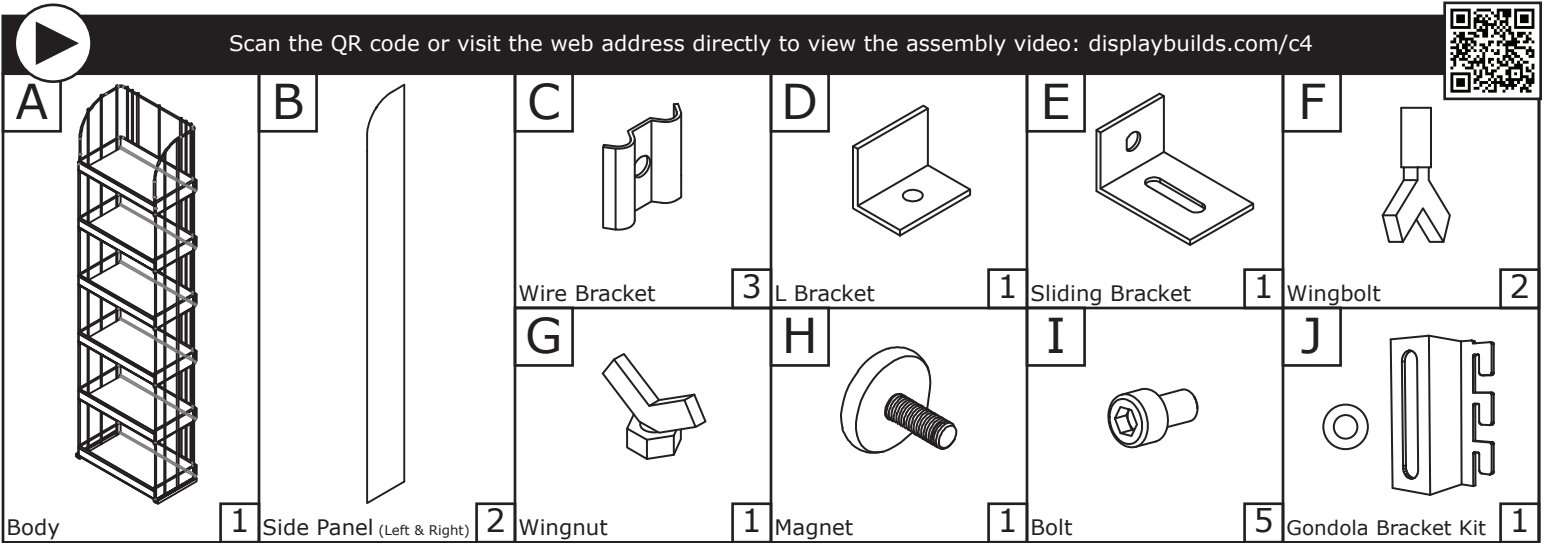

1 Slide (B) Side Panels into channel slides on (A) Body.

2 Install mounting bracketry as shown below and use option(s) best suited for location & stability.
A: Shelf Clamp Bracket **B:** Magnetic Bracket **C:** Gondola Hook

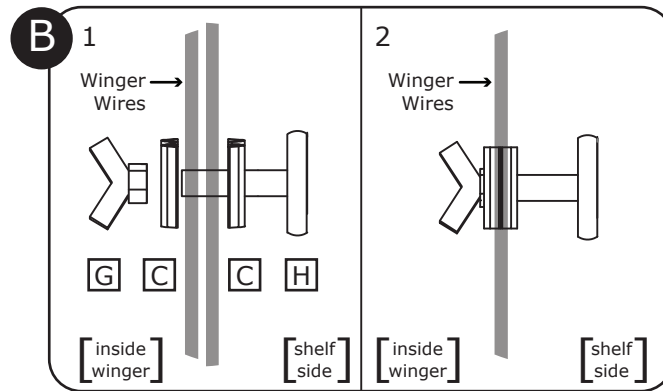
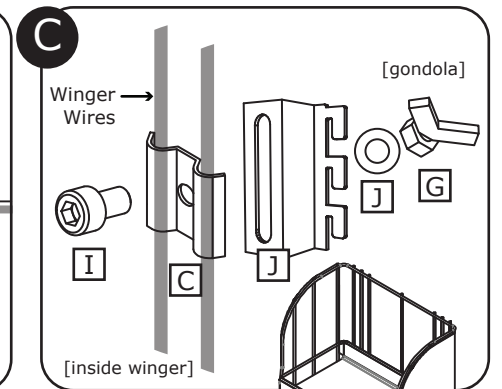
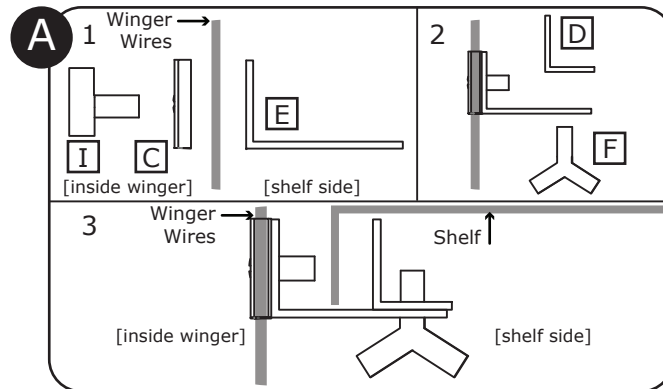

back of display

All bracket options attach to back of winger (A) Body between the two wires close to each other.



MISSING PARTS / DAMAGE CLAIM INSTRUCTIONS

- DO NOT** discard the box or original packaging.
In the case of damaged goods caused by shipping, photo evidence will be required.
- Take photos of the box & markings.
A photo of the markings (text) on the side of the box is required for all cases in which a replacement part is needed. This helps to identify the item number and ensures the correct parts are pulled.
- Take photos of damage (if applicable).
A photo of the damaged part(s) is always required to file a claim and expediently process the replacement part. Please make sure you keep the box even if it is damaged.
- Send an email with the images requested.
Email a description of the claim along with the images required above at displaybuilds.com/contact or directly to help@displaybuilds.com. Call our toll-free number 1-866-308-8368 for further assistance.